



# SEAFIELD

GOLF & SPA HOTEL



Thanks to our team of conference specialists, you'll enjoy the meticulous orchestration that only expertise and experience can assure.

With innovative approaches to solving your event problems and rigorous attention to detail, anything from a crucial sales conference to a bustling trade show will be carried off with style.



SEAFIELD GOLF AND SPA HOTEL doesn't just look the business, it's the ideal location for you to do business too. With a range of customised conferencing spaces accommodating anywhere from 8 to 550 people, and with a dedicated team ready to attend to every detail, here's the perfect location for your next meeting, banquet or conference. Needless to say, we can also fulfil your complete IT and AV requirements with state of the art solutions.

Just an hour from Dublin, with a wonderful coast hugging setting, not to mention its superb golf and exquisite OCEO SPA, it doesn't have to be all work and no play at the comfortably contemporary SEAFIELD GOLF AND SPA HOTEL. It's the perfect place for quality downtime too.

DON'T JUST MEET  
EXPECTATIONS - EXCEED THEM.  
A truly unique setting for your next  
meeting, conference or banquet.

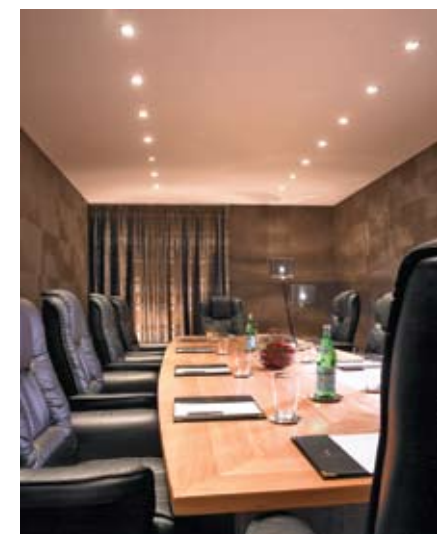



Our banqueting expertise is exceptional, with an imaginative range of delicious menus and wine options served by skilled, attentive staff. In short, SEAFIELD can make a triumph out of your next event, and an occasion out of your next function.



#### TO DINE FOR

Here you will dine fabulously. With skilled chefs, delicious, delightful spaces and warm welcomes, it's a recipe for success even before the first bottle's uncorked, the first course sampled. So if you're thinking of a venue, here's food for thought.

## CAPACITY CHART

### CONFERENCE AND BANQUET FACILITIES

	ÁINE CONFERENCE ROOM 1	TARA CONFERENCE ROOM 2	BOARD ROOM MEETING ROOM 1	CHULANN MEETING ROOM 2	DAILINN MEETING ROOM 3	PAVILION BANQUETING ROOM	
DIMENSIONS	464	108	30.6	30.6	71.8	288	APPROXIMATE AREA (m <sup>2</sup> )
	4985	1161	329	329	773	3100	APPROXIMATE AREA (ft <sup>2</sup> )
	24	13	8.5	8.5	11.4	24	LENGTH (m)
	19	8.3	3.6	3.6	6.3	12	WIDTH (m)
CAPACITY	550	100	14	14	75	180	MAXIMUM CAPACITY
	400	96			50	180	BANQUET
		32	14	14	30		BOARDROOM
	550	100			72		THEATRE
	200	50			30		CLASSROOM
		30			24		U-SHAPE

## FUNCTION ROOMS

### ÁINE

- 464 m<sup>2</sup>
- Max capacity 550 pax
- Touch screen room control system (lighting, projector, screen, sound)
- Ceiling mounted data, video and DVD projector
- Ceiling mounted retractable screen
- Full audio sound system with lapel, desk and handheld microphones
- Natural daylight
- Full air-conditioning
- Break out facilities

### TARA

- 108 m<sup>2</sup>
- Max capacity 100 pax
- Plasma screen
- Audio conferencing facilities
- DVD player
- Natural day light
- Full air-conditioning
- Break out facilities

## MEETING ROOMS

### BOARDROOM

- 30.6 m<sup>2</sup>
- Max capacity 14 pax
- Plasma screen
- Video and audio conferencing facilities
- Direct dial telephone
- Facsimile point
- DVD player
- Full air-conditioning

### DAILINN









- 71.8 m<sup>2</sup>
- Max capacity 75 pax
- Plasma screen
- Audio conferencing facilities
- Direct dial telephone
- Facsimile point
- DVD player
- Full air-conditioning

### CHULANN

- 30.6 m<sup>2</sup>
- Max capacity 14 pax
- Plasma screen
- Audio conferencing facilities
- Direct dial telephone
- Facsimile point
- DVD player
- Full air-conditioning

### ADDITIONAL SERVICES

- Computer workstations
- Copy service
- Wi-Fi technology
- Secretarial services
- Printers

-  POWER
-  TOILETS
-  INTERNET / DATA
-  BAR AREA
-  BREAKOUT AREA
-  TELEPHONE
-  TV, VIDEO & DVD
-  SOUND SYSTEM / SPEAKERS
-  SCREEN

MEETING ROOMS  
FIRST FLOOR

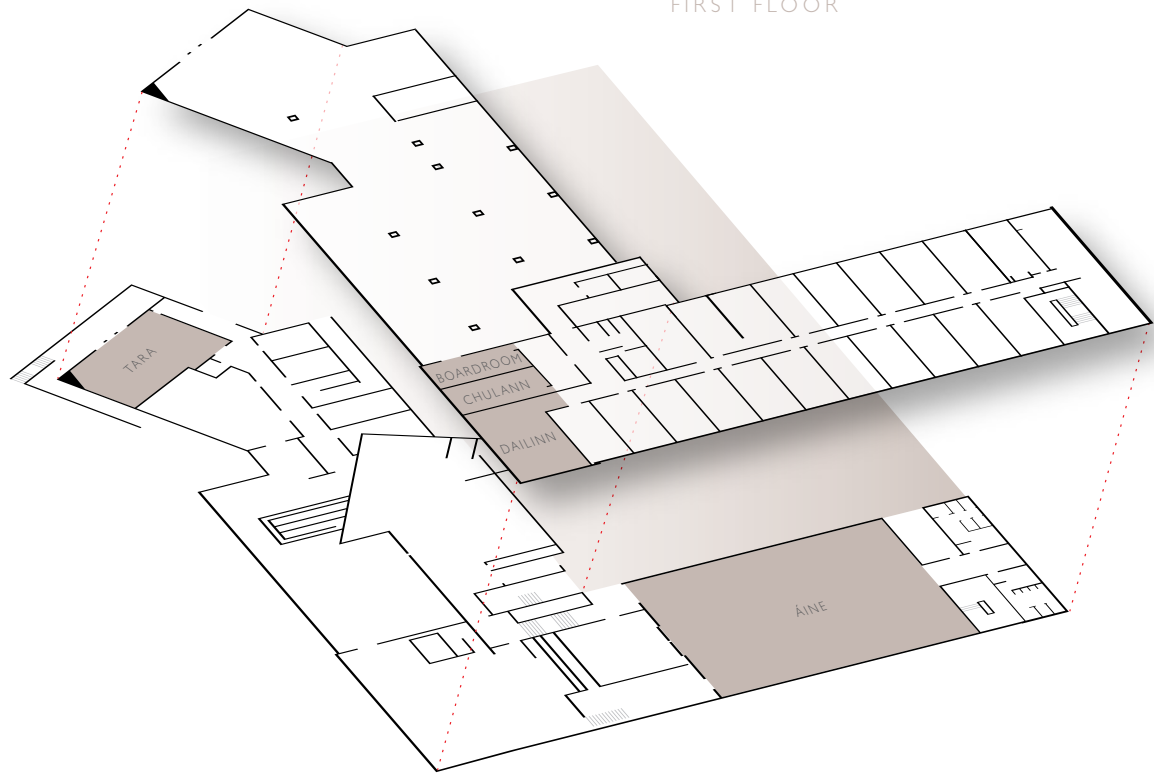

MEETING ROOMS  
GROUND FLOOR

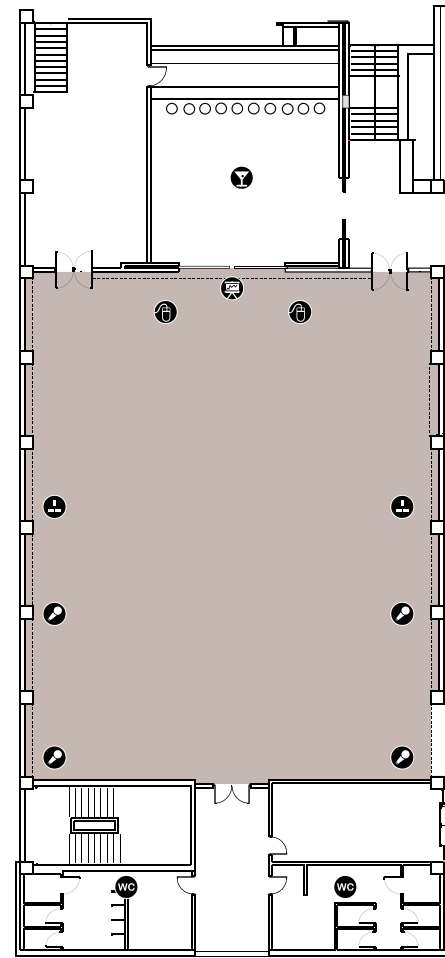

ÁINE  
FUNCTION ROOM 1

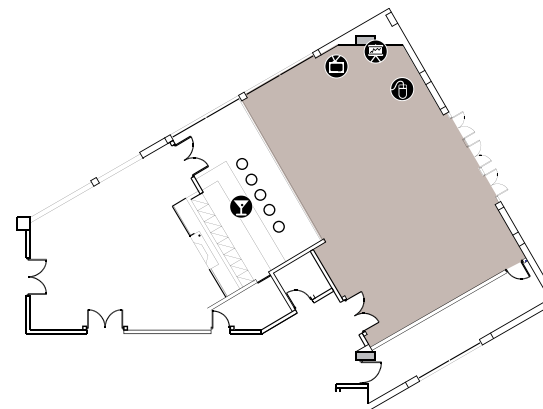

TARA  
FUNCTION ROOM 2

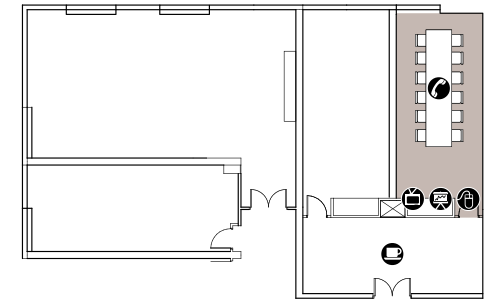

BOARDROOM  
MEETING ROOM 1

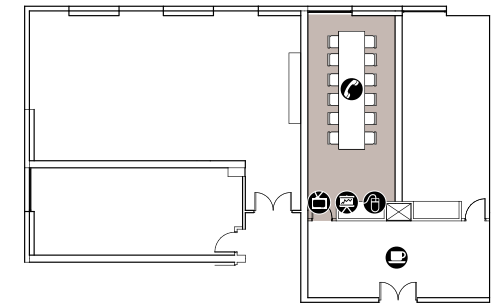

CHULANN  
MEETING ROOM 2

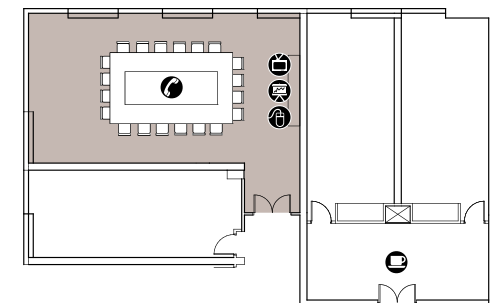

DAILINN  
MEETING ROOM 3



When it comes to corporate events or banquets, it turns out you can have it all in a fantastic location not far from the capital. Flexible facilities to suit all occasions. Luxurious accommodation, delicious dining and a relaxing ambience, SEAFIELD GOLF AND SPA HOTEL has all this and more.

Here, attention to detail is evident in everything we do. It's this focus on the minutiae that takes the burden off the organiser's desk. Frankly, there's little we haven't seen before. And if you surprise us, all the better – we love to rise to a challenge.



#### TURN A MEETING INTO A HAPPENING

Unashamedly contemporary, timelessly stylish, practically flexible, it's the perfect environment to make your event fly. Coming to Seafield makes it look easy - putting people at ease whilst facilitating business effortlessly.

SEAFIELD is no ordinary hotel, here is a very special venue in a very special location. With a splendid golf course that curves along the coast and a world class spa to ease away the stresses of work and life, our guests find themselves transported to another world. Yet just an hour south of Dublin.

Here is a remarkable celebration of true excellence, realised in a destination that will seduce the senses and free your spirit. More than a hotel, it's an unforgettable experience.

Make light of organising your next business outing, conference or banquet thanks to the ever-welcoming SEAFIELD GOLF AND SPA HOTEL.

#### BOOKINGS

For all corporate, banqueting and hotel enquires call;  
T. 053 9424000 or email your interest to  
[sales@seafieldhotel.com](mailto:sales@seafieldhotel.com)

#### DIRECTIONS

FROM DUBLIN take Exit 22 off the N11  
Follow the signs to Ballymoney.

FROM WEXFORD take Exit 23 off the N11  
Follow the signs to Ballymoney.

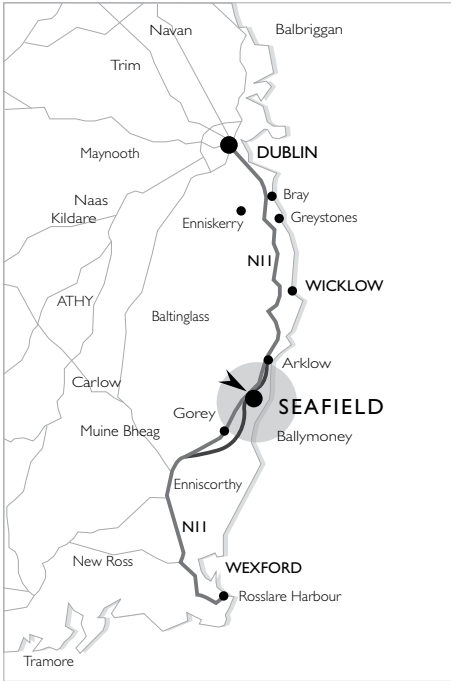

#### SEAFIELD GOLF & SPA HOTEL

BALLYMONEY T: + 353 (0) 53 9424 000 E: [SALES@SEAFIELDHOTEL.COM](mailto:SALES@SEAFIELDHOTEL.COM)  
GOREY F: + 353 (0) 53 9424 050 [WWW.SEAFIELDHOTEL.COM](http://WWW.SEAFIELDHOTEL.COM)  
CO.WEXFORD



**SEAFIELD**  
GOLF CLUB



**OCEO**  
SPA



**SEAFIELD**  
PROPERTY